

SECTION A-A

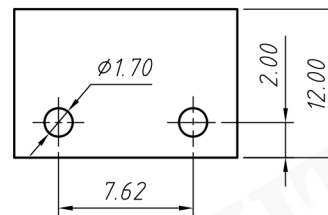

Material
Housing: PA66, UL94V-0
Pin header: Brass, Tin plated
Nut: M2.5 Brass

Electrical
Rated voltage: 300V
Rated current: 15A
Contact Resistance: 20 mΩ
Insulation resistance: 500MΩ/DC500V
Withstand voltage: AC2000V / 1 min

Mechanical
Temp. Range: -40 °C ~ +105 °C

Order Information

RE - C - EDRC - 7.62 - XXP - 4 00

RoHS ————
Terminal Block ————
Pitch ————
No.: of Pole ————
Color: 4- Green ————
Product Code: 00 ~ 99 ————

UNITS:mm	SHEET SIZE:A4		SCALE: ---
> 0 ~ 3	> 3 ~ 18	> 18 ~ 50	> 50 ~ 120
± 0.12	± 0.15	± 0.3	± 0.5

