

PCB Layout

**CIM100V5 alternative**  
**Part No 2BCEVM-5.08-10P-14-100AH**  
 PC-STIFTLLEISTE, GERADE, 10 POL., RM 5.08MM

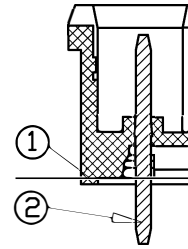

REV	CONTENT	CHK	DATE
V0.0	CONTENT	MYZ	21.07.06



SECTION A-A

**Electrical :**

- |   |               |      |
|---|---------------|------|
|   | UL            | IEC  |
| 1.Rated Voltage :                         | 300V          | 320V |
| 2.Rated Current :                         | 15A           | 20A  |
| 3.Withstanding Voltage :                  | AC1600V/1Min. |      |
| 4.Operating Temperature :                 | -40°C~+105°C  |      |
| 5. RoHS Compliance                        |               |      |
| 6.Safty Approval :                        | cULus CE      |      |
| 7." ★ " is the key quality control point. |               |      |

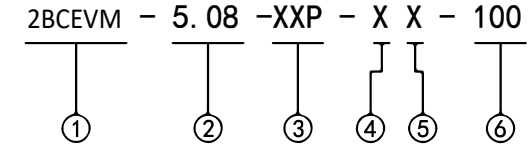
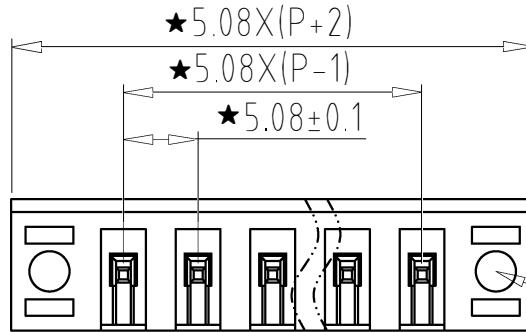
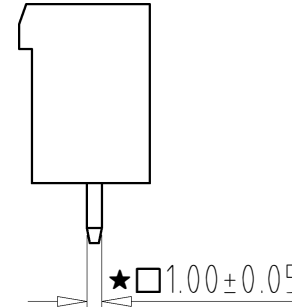
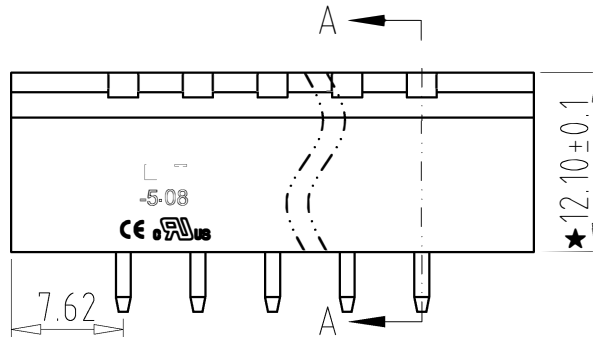
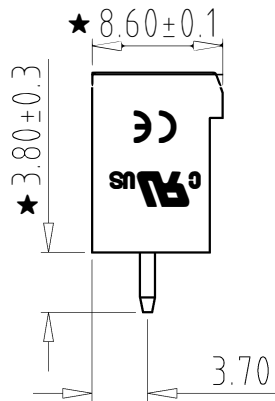

- ① Series No.      ④ 1 Single Pitch
- ② Pitch            ⑤ Color: 1 Grey  
                          2 Blue  
                          3 Black  
                          4 Green  
                          5 Orange  
                          6 Red  
                          7 Transparent  
                          8 Yellow  
                          9 White
- ③ Poles  
 02 02Contacts  
 03 03Contacts  
 ... 24 24Contacts
- ⑥ Customer Request: 100--Standard

3	NUT	XX	2	BRASS	--
2	PIN	XX	P	BRASS	Tin Plated
1	HOUSING	XX	1	PA66 UL94V-0	SEE NOTE
ITEM	NAME OF PART	NO. OF PART	Q'TY	MATERIAL	NOTE
DWG.	MYZ	DATE	21.07.06	SIZE	A4 UNITS mm SHEET/OF 1/1
CHK.		DATE		SCALE	1:1
APP.		DATE		NAME	2BCEVM-5.08-XXP-XX-100
				DWGNO.	XXXX

Total Pitch Tolerances in mm										Nominal dimension range in mm										⊥	=	-	//						
over 0	over 30	over 53	over 70	over 90	over 115	over 150	over 250	over 350	over 500	over 0	over 30	over 53	over 70	over 90	over 115	over 150	over 200	over 250	over 320	over 0	over 10	all	over 0	over 100	over 150				
to 30	to 53	to 70	to 90	to 115	to 150	to 250	to 350	to 500	to 500	to 30	to 53	to 70	to 90	to 115	to 150	to 200	to 250	to 320	to 10	to 10	to 10	to 10	to 100	to 150	to 150				
±0.18	±0.20	±0.25	±0.3	±0.35	±0.44	±0.60	±0.70	±0.85	±0.20	±0.25	±0.30	±0.35	±0.44	±0.55	±0.70	±0.80	±0.90	0.2	0.3	0.3	0.2	0.3	0.5						

