

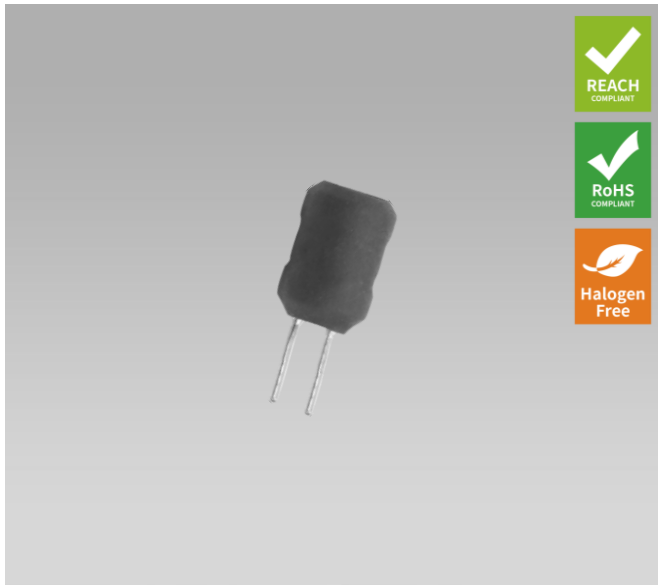

Radial Power Choke / Coils COD0912 Series



Outline: 产品概要

- High reliability, high consistency inductance.
高可靠性，电感值一致性好。
- Lead free product, RoHS compliant.
无铅产品，符合 RoHS 指令。
- Core is encapsulated by UL heat shrink tube to provide excellent mechanic and environmental protection.
整体包覆在 UL 热缩套管内，提供极佳的机械和环境保护。
- Widely used in power supply, DC-DC converter, computer and peripherals, air-condition, home electric appliance, and etc.
适用于电源，DC-DC 转换器，电脑及其外围设备，空调，家用电器等。
- Operating temperature : -40°C ~ +125°C
(Including coil's temperature rise)
工作温度：-40°C ~ +125°C (包含线圈发热)

1 Appearance and Dimensions (mm) 外形尺寸

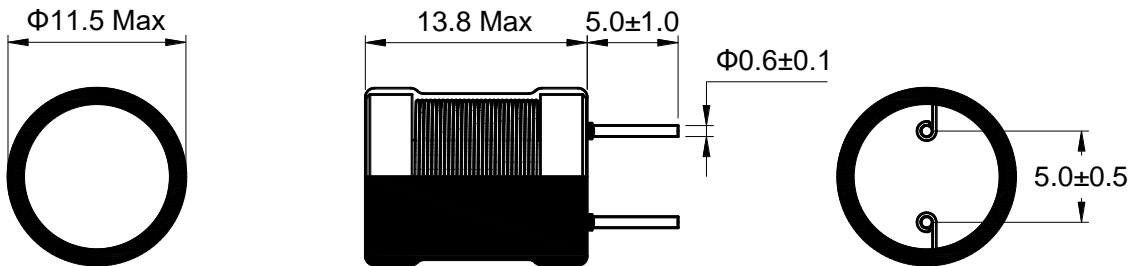

2 Marking 印字标识



3 Reference Hole pattern (mm) 参考焊孔尺寸

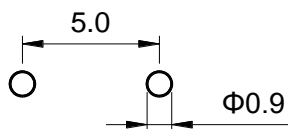

4 Schematic 原理图

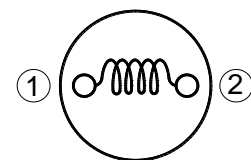

※ Marking is available if needed.
如果需要，产品可印字。



Radial Power Choke / Coils COD0912 Series

5 Electrical Characteristics

电气特性

Part No. 型号	Inductance (μH) 电感值 ×1 ±10%	D.C.R. (mΩ) 直流电阻		Saturation current (A) 饱和电流 ×2 Typical	Temperature rise current (A) 温升电流 ×3 Typical
		Typical	Max		
COD0912-100K	10.0	17.7	21.2	4.80	5.60
COD0912-120K	12.0	19.1	22.9	4.70	5.37
COD0912-150K	15.0	22.4	26.9	4.40	4.96
COD0912-180K	18.0	25.3	30.4	4.10	4.73
COD0912-220K	22.0	28.2	33.8	3.20	4.43
COD0912-270K	27.0	32.3	38.8	3.10	4.13
COD0912-330K	33.0	41.1	49.3	2.80	3.66
COD0912-390K	39.0	45.2	54.3	2.70	3.49
COD0912-470K	47.0	57.7	69.3	2.35	3.05
COD0912-560K	56.0	63.7	76.4	2.10	2.97
COD0912-680K	68.0	71.4	85.7	2.00	2.78
COD0912-820K	82.0	91.4	110	1.90	2.36
COD0912-101K	100	105	125	1.65	2.21
COD0912-121K	120	139	167	1.55	1.94
COD0912-151K	150	162	195	1.45	1.84
COD0912-181K	180	183	220	1.32	1.73
COD0912-221K	220	231	278	1.15	1.54
COD0912-271K	270	262	315	1.08	1.45
COD0912-331K	330	333	399	0.97	1.27
COD0912-391K	390	408	490	0.88	1.13
COD0912-471K	470	477	572	0.82	1.08
COD0912-561K	560	578	694	0.74	0.96
COD0912-681K	680	722	866	0.61	0.87
COD0912-821K	820	810	972	0.56	0.83
COD0912-102K	1,000	1,093	1,312	0.48	0.69

- All data is tested based on 25°C ambient temperature.

所有数据基于环境温度 25°C条件下测试。

- ※1 Inductance measure condition at 1kHz,0.25V.

电感测试条件为 1kHz,0.25V。

- ※2 Saturation current : the value of DC current when the inductance decrease 20% of its initial value.

饱和电流：电感值下降其初始值的 20%时所加载的直流电流值。

- ※3 Temperature rise current : the actual value of DC current when the temperature rise is ΔT40°C(Ta=25°C).

温升电流：使产品温度上升到 ΔT40°C时所加载的实际直流电流值(Ta=25°C)。

- ※ Special remind : Circuit design, component placement, PCB size and thickness, cooling system and etc. all will affect the product temperature. Please verify the product temperature in the final application.

特别提醒：线路设计，组件布局，印刷线路板(PCB)尺寸及厚度，散热系统等均会影响产品温度。请务必在最终应用时，验证产品发热状况。



**Radial Power Choke / Coils
COD0912 Series**

6 Saturation Current vs Temperature Rise Current Curve

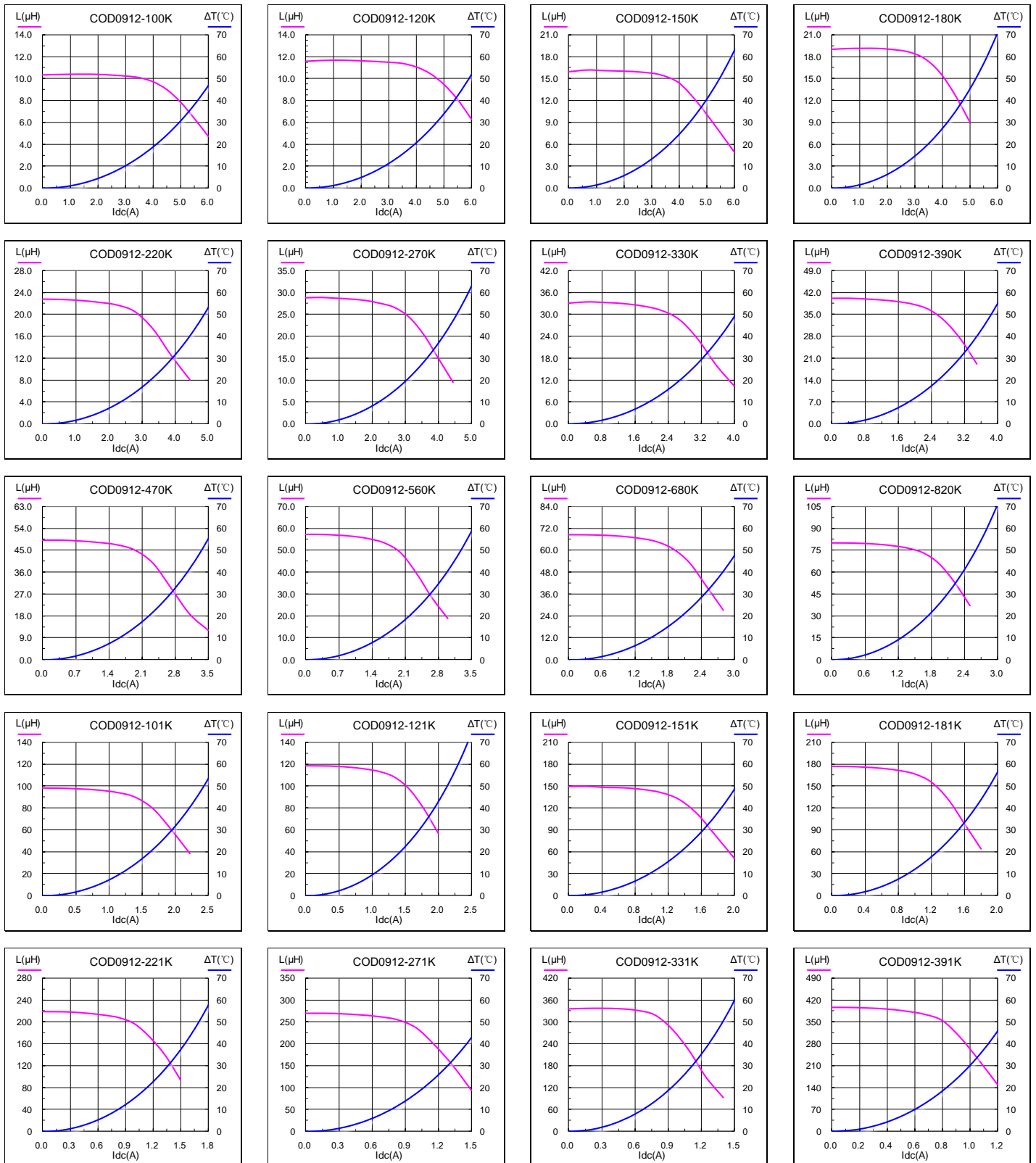



Radial Power Choke / Coils COD0912 Series

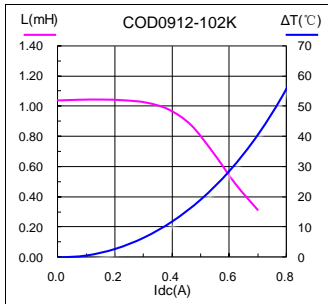
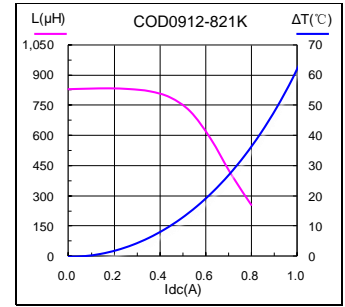
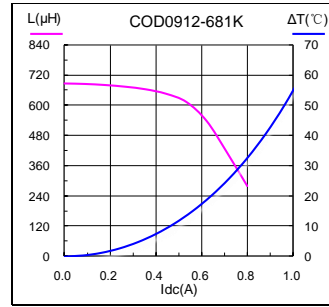
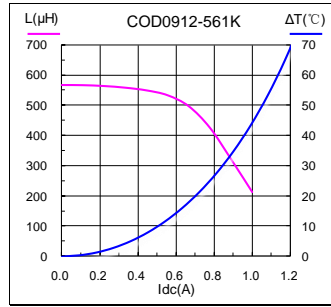
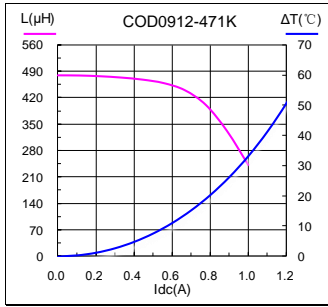



Radial Power Choke / Coils COD0912 Series

7 Packing Specification

包装规格

7.1 Packing 包装

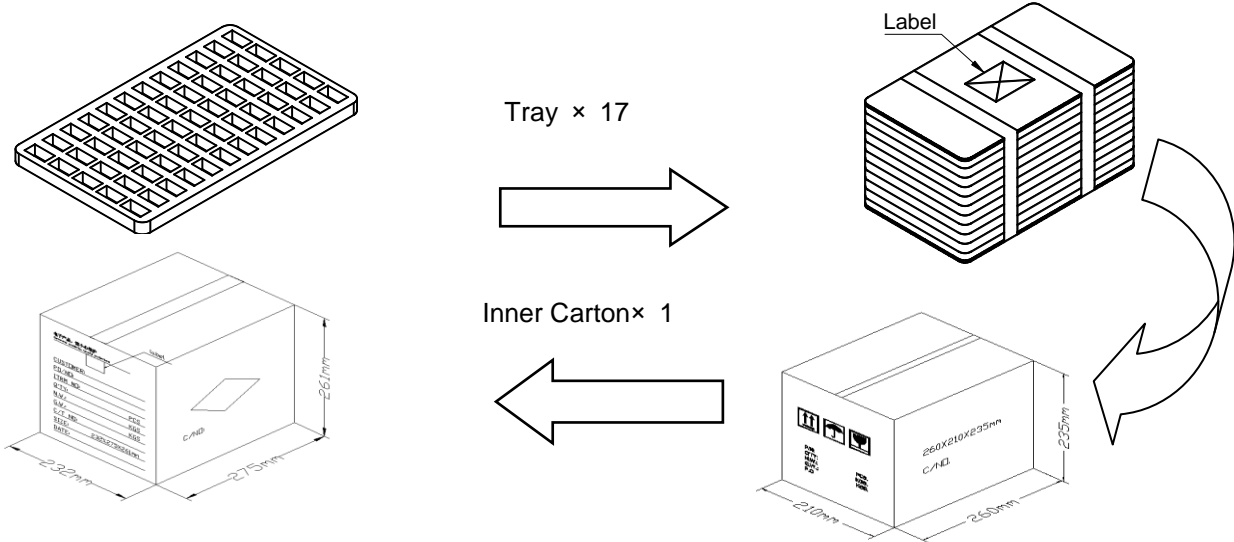

7.2 Carton Dimensions and Packing Quantity 包装箱尺寸和包装数量

■ Inner Carton : 260×210×235mm
内包装盒

■ Out Carton : 275×232×261mm
外包装箱

Product Series 产品系列	Quantity / Tray 数量 / 盘	Inner Carton Quantity 内盒 包装数量	Out Carton Quantity 外箱 包装总数量
CM0912	120pcs	(120×17) = 2040pcs	(2040×1) = 2040pcs

7.3 Label Making 标签标识

The following items will be marked on the reel of product label and shipping label.
以下项目将明确标识于产品卷盘标签以及运输标签上。

**Production Label
产品标签**

- Packing No.
包装流水号
- Quantity
数量
- Shipment Date
出货日期
- Part No.
产品型号
- Customer Part No.
客户型号
- Customer Po No.
客户订单号

**Shipping Label
运输标签**

- Packing No.
包装流水号
- Quantity
数量
- Shipment Date
出货日期
- Part No.
产品型号
- Customer Part No.
客户型号
- Customer Po No.
客户订单号