

Toroidal Coil

- RoHS Compliant
- Operating Temperature 0°C to +70°C
- Storage Temperature -40°C to +85°C

Electrical Specifications @25°C	
Inductance	PIN 1-2= 4.7mH ±30% @ 10kHz/0.1V
	PIN 4-3= 4.7mH ±30% @ 10kHz/0.1V
D.C.R.	PIN 1-2 = 900 mohm Max.
	PIN 4-3 = 900 mohm Max.
Turn Ratio	PIN1-2 : PIN 4-3 = 1±2% :1
Hi-pot	PRI. – SEC. =750VAC/2Seconds/1mA

Dimensions

(Units: $\frac{\text{Inches}}{\text{mm}}$, Unless otherwise specified, all tolerances are $\pm\frac{.010}{0.25}$)

Schematic

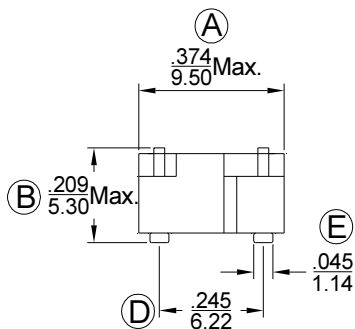
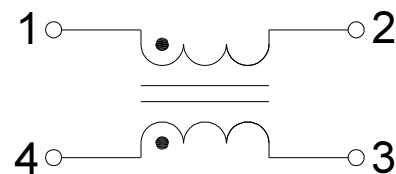
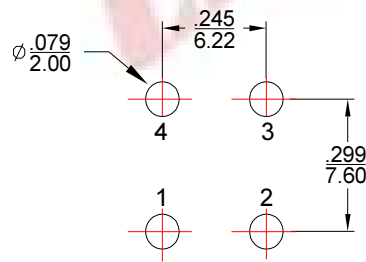
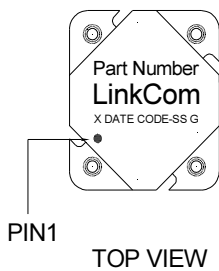

SUGGESTED PAD LAYOUT

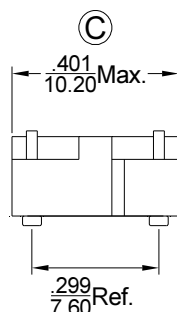

Mark:

1. Part Number---LTC0265
2. X---PRODUCT LINE or BLANK
3. DATE CODE---YYWW
4. SS---50 or BLANK
5. G---RoHS

Package info

LTC0265-50R - Tape reel