

Current Sense Transformers

- Designed to meet UL 60950-1 and IEC 60950-1 requirements for reinforced insulation
- RoHS Compliant
- Operating Temperature -40°C to +125°C
- 4000Vrms isolation for 60 seconds between windings
- Frequency range 400Hz to 1MHz
- Up to 40A of rated current on primary

Electrical Specifications @25°C

Part Number	Turns Ratio Pri. : Sec.	Secondary Inductance Min.(mH)	DCR		Volt-time product on Sec. Max.(V-μsec)	Terminating Resistance (1VSec./40APri.) (Ω)
			Pri. Max.(mΩ).	Sec. Max.(Ω)		
LCS0050-50	1:70	3.46	0.84	0.83	277	1.75
LCS0051-50	1:100	7.07	0.84	1.23	395	2.5
LCS0052-50	1:200	28.28	0.84	3.95	791	5.0
LCS0053-50	1:300	63.63	0.84	7.84	1186	7.5

Dimensions

(Units: $\frac{\text{mm}}{\text{Inches}}$, Unless otherwise specified, all tolerances are $\pm \frac{0.25}{[.010]}$)

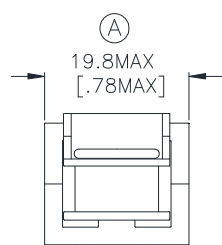

TOP VIEW

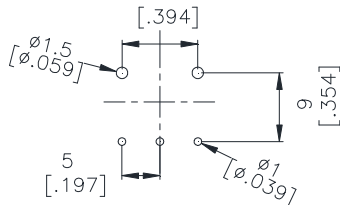

SUGGESTED PCB LAYOUT

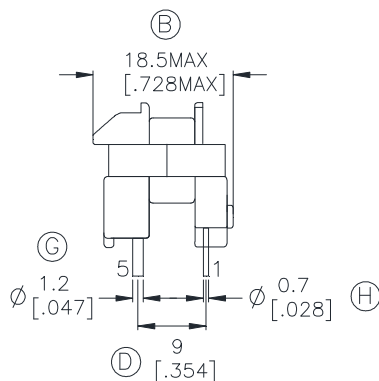
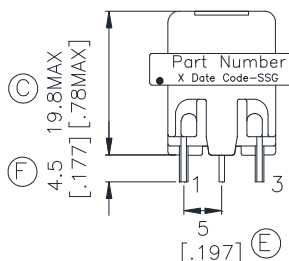

Schematic

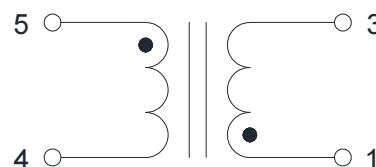

Mark

1. Part Number---LCSxxxx
2. X---PRODUCT LINE OR BLANK
3. DATE CODE---YYWW
- 4.SS---50 OR BLANK
5. G---RoHS

Package info

LCSxxxx-50P - Tray